

Quick Release Funny Car Parachute Mounting Diagram

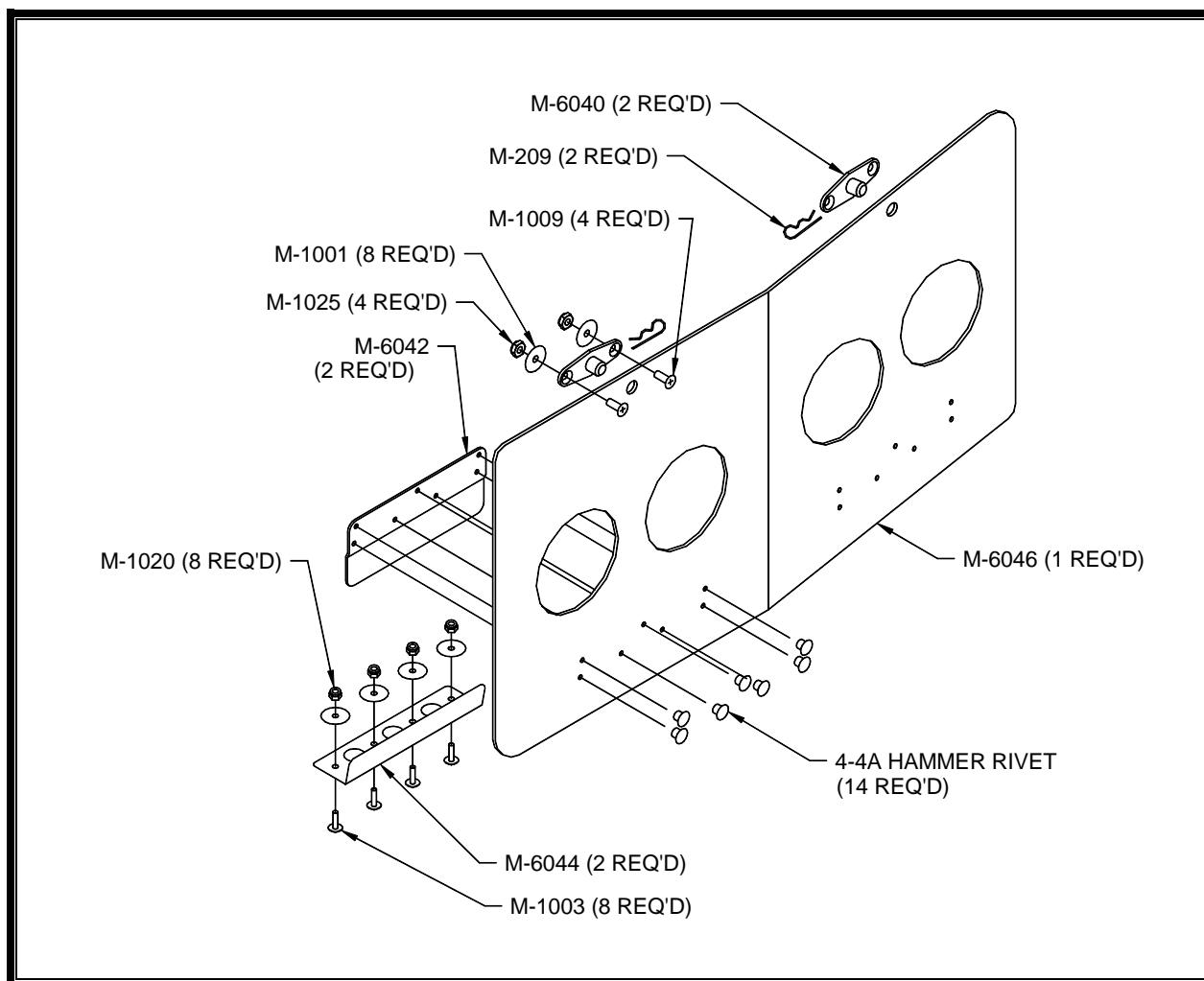

FIG. 1

Rivet the M-6042 Offset Angles to the M-6046 Parachute Mounting Plate. Item M-6044 is drilled and mounted to the body, allowing part M-6042 to slide between the body and part M-6044. This captures the lower end of the M-6040 Series assembly. The M-6046 plate is then pushed over the M-6040 Pins (which can now be drilled and mounted to the body) and the M-209 hair pins hold the plate in place.

Shop ONLINE at www.mckinneycorp.com

4710 Fastline Dr. Lafayette, IN 47905
765-448-4800