

Roll Cage Kit Form

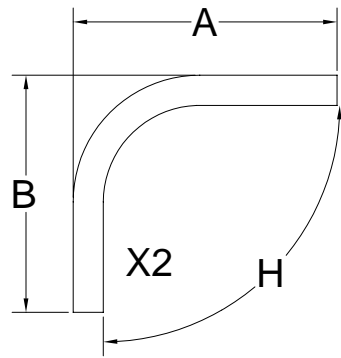

Tubing Size: _____

A: _____

B: _____

C: _____

D: _____

E: _____

F: _____

G: _____

H: _____

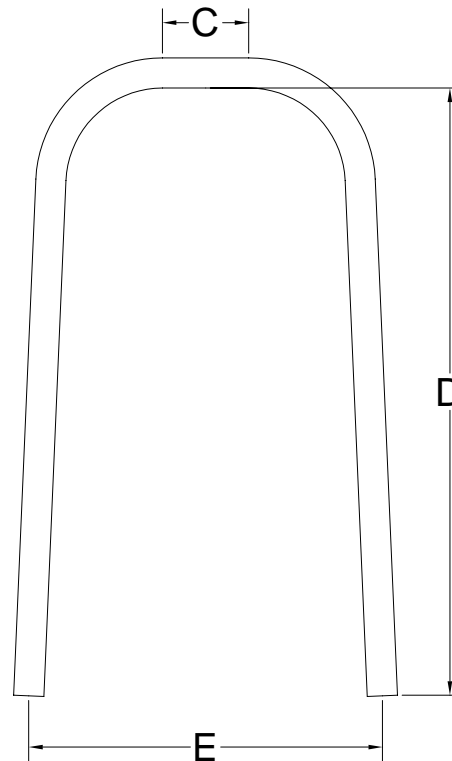

"C" is the length of straight required. This dimension will be the amount of flat needed, **NOT** the bend to bend dimension.
5" Minimum.

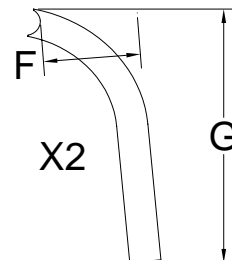

"F" Dimension is from the end of the tube to outside edge.